

Plat Book MMM. Page 147A

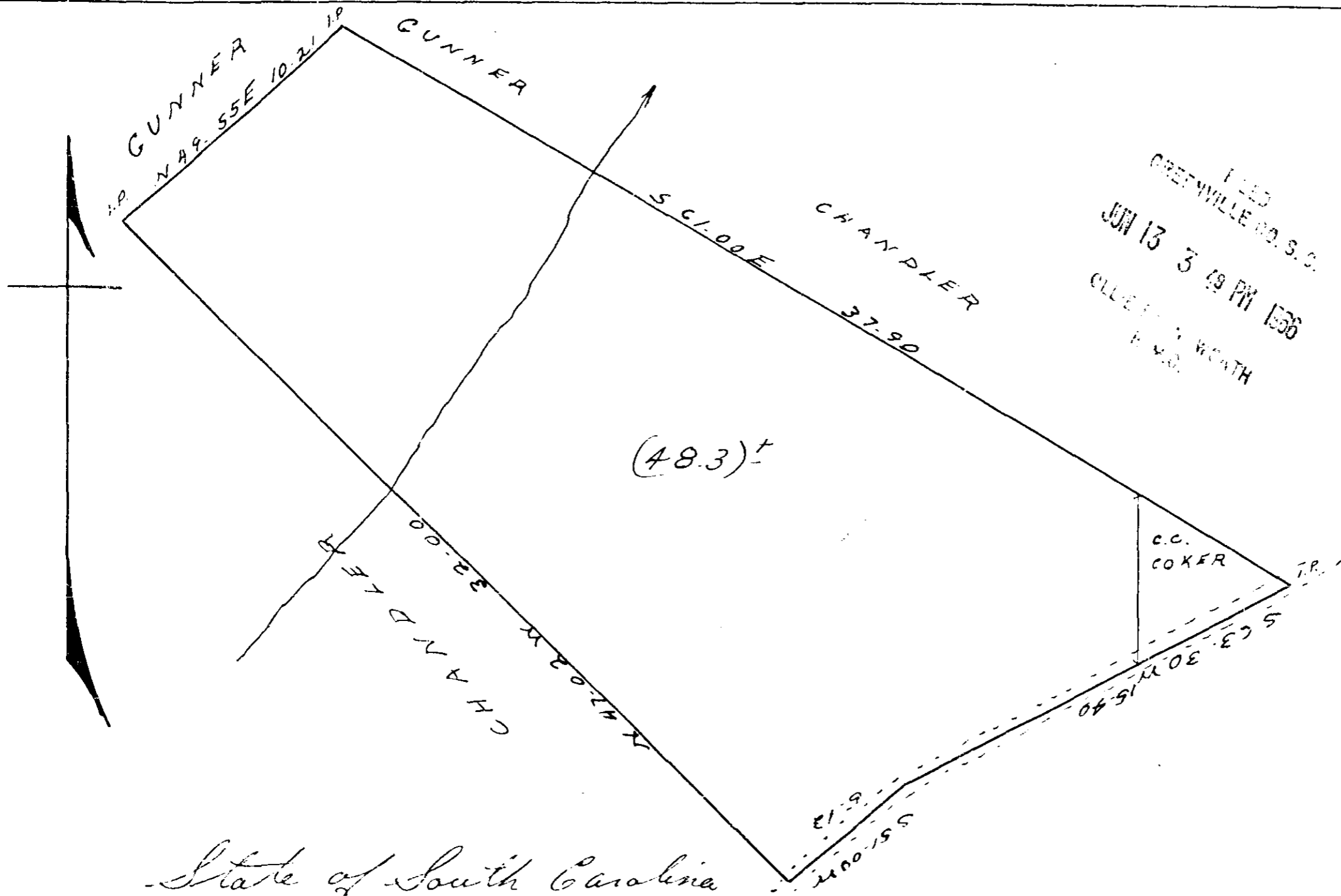

35326 Filed This 13 day of June 1950
 And Recorded in MMM Page 147 at 2:48 PM
Ollie Starnworth
 Register Mesne Conveyance Greenville County, S. C.

State of South Carolina
 Greenville County

The above plat represents a portion of land formerly of the
 Brown Est. Said portion - lies on North Side of Old Hundred
 road. Above plat taken in (148) of an acre deeded to C.C. Coker.
 Surveyed at the request of D. F. Coker, June 9, 1950

1" = 5069 INCHES M.M.W. - 147 John C. Smith